 <p> FAX: (255 22) 2844300, 2844302 PHONE: (255 22) 2198100 AFS: HTDQYOYO Email: tcaa@tcaa.go.tz, ais@tcaa.go.tz Website: www.tcaa.go.tz </p>	<p align="center"> UNITED REPUBLIC OF TANZANIA TANZANIA CIVIL AVIATION AUTHORITY Aeronautical Information Management Nyerere/ Kitunda Road Junction Aviation House, 1st Floor, P.O. Box 2819, DAR ES SALAAM </p>	<p align="center"> AIP Supplement 02/26 Published on 02 JAN 2026 </p>
Document No: TCAA/FRM/ANS/AIM - 56	Title: AIP Supplement	Page 1 of 3

AERODROMES (AD)

S02 Kigoma Airport – HTKA

Kigoma Airport (HTKA) is undergoing Apron rehabilitation commenced on 1st September 2025 and expected to be completed on 28th February 2026, the work is focusing on the expansion of the apron and closure of taxiways to improve airside infrastructure.

Phase 1: COMPLETED (03 October 2025 to 31 October 2025)

- Reduction of Apron Area:
The current apron area of 15,000 m² will be reduced to 6,400 m².
The new dimensions of the apron will be 80 meters (width) by 80 meters (length).
The apron will accommodate two aircraft parking stands, including one designated for refueling.
- Taxiway Status:
Taxiway B (TWYB) will be closed.
Taxiway A (TWYA) will be opened and operational.

Phase 2: From 2 January 2026 to 28 February 2026

- Taxiway Status:
Taxiway A (TWY A) will be closed.
Taxiway B (TWY B) will be opened and operational.
- Finalization of Apron Works:
Continued finishing work including marking and signage updates

Operational Notes:

- Aircraft Night Stops:
As with Phase 1, operators intending to night-stop must provide at least 12 hours prior notice to ensure apron availability and coordination.
- Movement Restrictions:
Aircraft will be directed via TWY A by Air Traffic Controller and ground Marshaller will give signal to a Pilot for aircraft parking stand assignments.

(Cancel AIP SUP 35/25)

See Attachments to this AIP Supplement

ATTACHMENT PHASE ONE TO AIP SUP 02/26

AERODROME CHART - ICAO 04°53'03.66"S 029°40'11.74"E ELEV 2681 ft TWR 118.4/123.7 KIGOMA Kigoma Airport

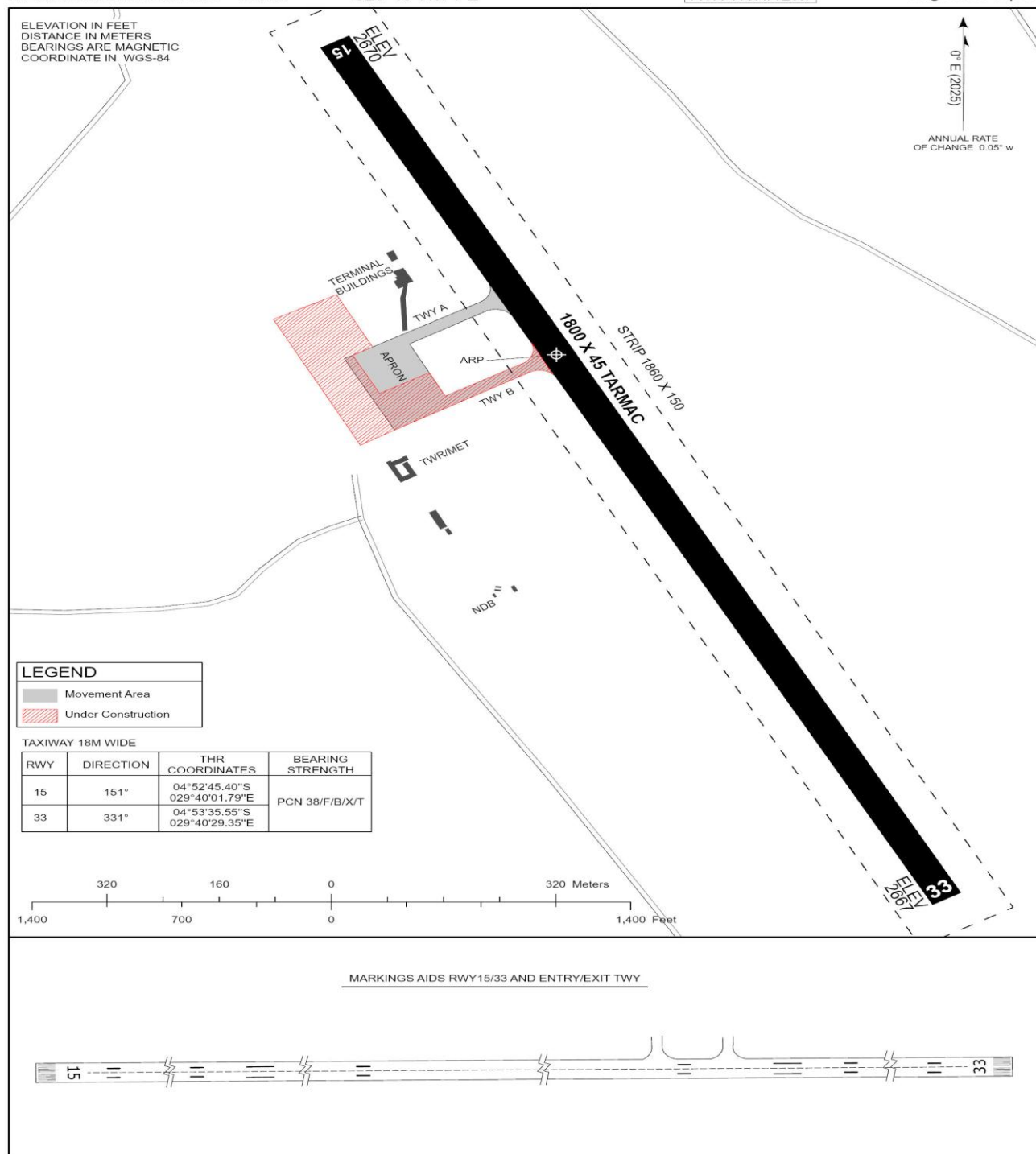

TANZANIA CIVIL AVIATION AUTHORITY

02 January 2026

ATTACHMENT PHASE TWO TO AIP SUP 02/26

AERODROME CHART - ICAO

04°53'03.66"S
029°40'11.74"E

ELEV 2681 ft

TWR 118.4/123.7

KIGOMA
Kigoma Airport

ELEVATION IN FEET
DISTANCE IN METERS
BEARINGS ARE MAGNETIC
COORDINATE IN WGS-84

0° E (2025)
ANNUAL RATE
OF CHANGE 0.05° W

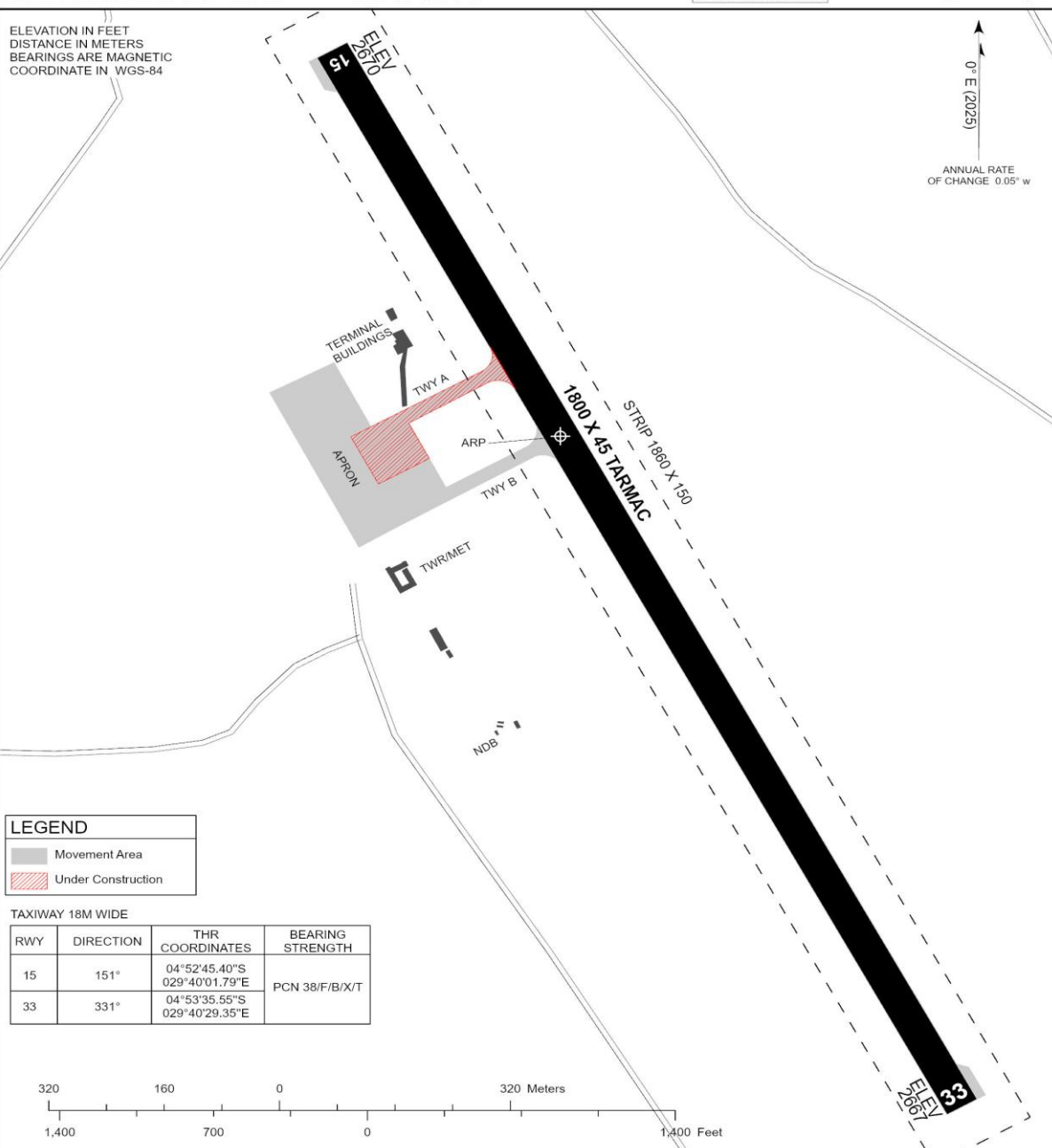

MARKINGS AIDS RWY15/33 AND ENTRY/EXIT TWY



TANZANIA CIVIL AVIATION AUTHORITY

02 January 2026